

NESTER TOWNSHIP 2021 - 2026 PRESERVATION/STRUCTURAL IMPROVEMENT PLAN

Nester Millage amount of \$11,713 per year

Rev. 6/18/2020

ROAD	SEGMENT	2019 RATING	MILEAGE	TREATMENT	ESTIMATED COST
2021 ROAD PLAN				2020 CARRY FORWARD	\$12,363.13
				2021 ALLOCATION	\$25,102.67
				TOTAL ALLOCATION	\$37,465.80
Muma Rd	Nolan Rd to End	N/A	1.34	Add 3" Gravel	\$41,250.00
				2021 TOTAL ALLOCATION	\$41,250.00 \$23,628.88
				MILLAGE	\$11,713.24
				TOWNSHIP COST	\$5,907.88

Carry Forward 2021 Allocation amount of \$13,836.92 to 2022

Carry Forward 2021 Millage amount of \$3,476.27 to 2022

ROAD	SEGMENT	2019 RATING	MILEAGE	TREATMENT	ESTIMATED COST
2022 ROAD PLAN				2021 CARRY FORWARD	\$13,836.92
				2022 ALLOCATION	\$25,787.29
				TOTAL ALLOCATION	\$39,624.21
Dunham Lake Rd	F-18 to Seasonal Road	N/A	1.77	Add 3" Gravel	\$65,486.36
				2022 TOTAL ALLOCATION	\$65,486.36 \$37,456.47
				MILLAGE	\$18,665.78
				TOWNSHIP COST	\$9,364.11

Carry Forward 2022 Allocation amount of \$2,167.74 to 2023

ROAD	SEGMENT	2019 RATING	MILEAGE	TREATMENT	ESTIMATED COST
2023 ROAD PLAN				2022 CARRY FORWARD	\$2,167.74
				2023 ALLOCATION	\$26,471.91
				TOTAL ALLOCATION	\$28,639.65
No Project					\$0.00
				2023 TOTAL	\$0.00
				ALLOCATION	\$0.00
				MILLAGE	\$0.00
				TOWNSHIP COST	\$0.00

Carry Forward 2022 and 2023 Allocation amount of \$28,639.65 to 2024

Carry Forward 2023 Millage amount of \$15,189.51 to 2024

ROAD	SEGMENT	2019 RATING	MILEAGE	TREATMENT	ESTIMATED COST
2024 ROAD PLAN				2022 and 2023	
				CARRY FORWARD	\$28,639.65
				2024 ALLOCATION	\$27,156.53
				TOTAL ALLOCATION	\$55,796.18
Matthews Rd	Sargent Rd to F-18	N/A	1.00	Add 3" Gravel	\$37,500.00
Matthews Rd	F-18 to Seasonal Road	N/A	1.00	Add 3" Gravel	\$37,500.00
				2024 TOTAL	\$75,000.00
				ALLOCATION	\$35,696.78
				MILLAGE	\$30,379.02
				TOWNSHIP COST	\$8,924.20

Carry Forward 2024 Allocation amount of \$20,099.40 to 2025

ROAD	SEGMENT	2019 RATING	MILEAGE	TREATMENT	ESTIMATED COST
2025 ROAD PLAN				2024 CARRY FORWARD	\$20,099.40
				2025 ALLOCATION	\$27,156.53
				TOTAL ALLOCATION	\$47,255.93
Muma Rd	F-97 to Nolan Rd	N/A	0.50	Add 3" Gravel	\$18,500.00
Nolan Rd	F-18 to Muma Rd	N/A	1.51	Add 3" Gravel	\$55,759.42
				2025 TOTAL	\$74,259.42
				ALLOCATION	\$47,255.93
				MILLAGE	\$15,189.51
				TOWNSHIP COST	\$11,813.98

ROAD	SEGMENT	2019 RATING	MILEAGE	TREATMENT	ESTIMATED COST
2026 ROAD PLAN				2025 CARRY FORWARD	\$0.00
				2026 ALLOCATION	\$27,156.53
				TOTAL ALLOCATION	\$27,156.53
Nolan Road	End of Pavement to F-18	N/A	0.84	Add 3" Gravel	\$49,135.17
				2025 TOTAL	\$49,135.17
				ALLOCATION	\$27,156.53
				MILLAGE	\$15,189.51
				TOWNSHIP COST	\$6,789.13

NESTER TOWNSHIP MAP

PROPOSED MILLAGE

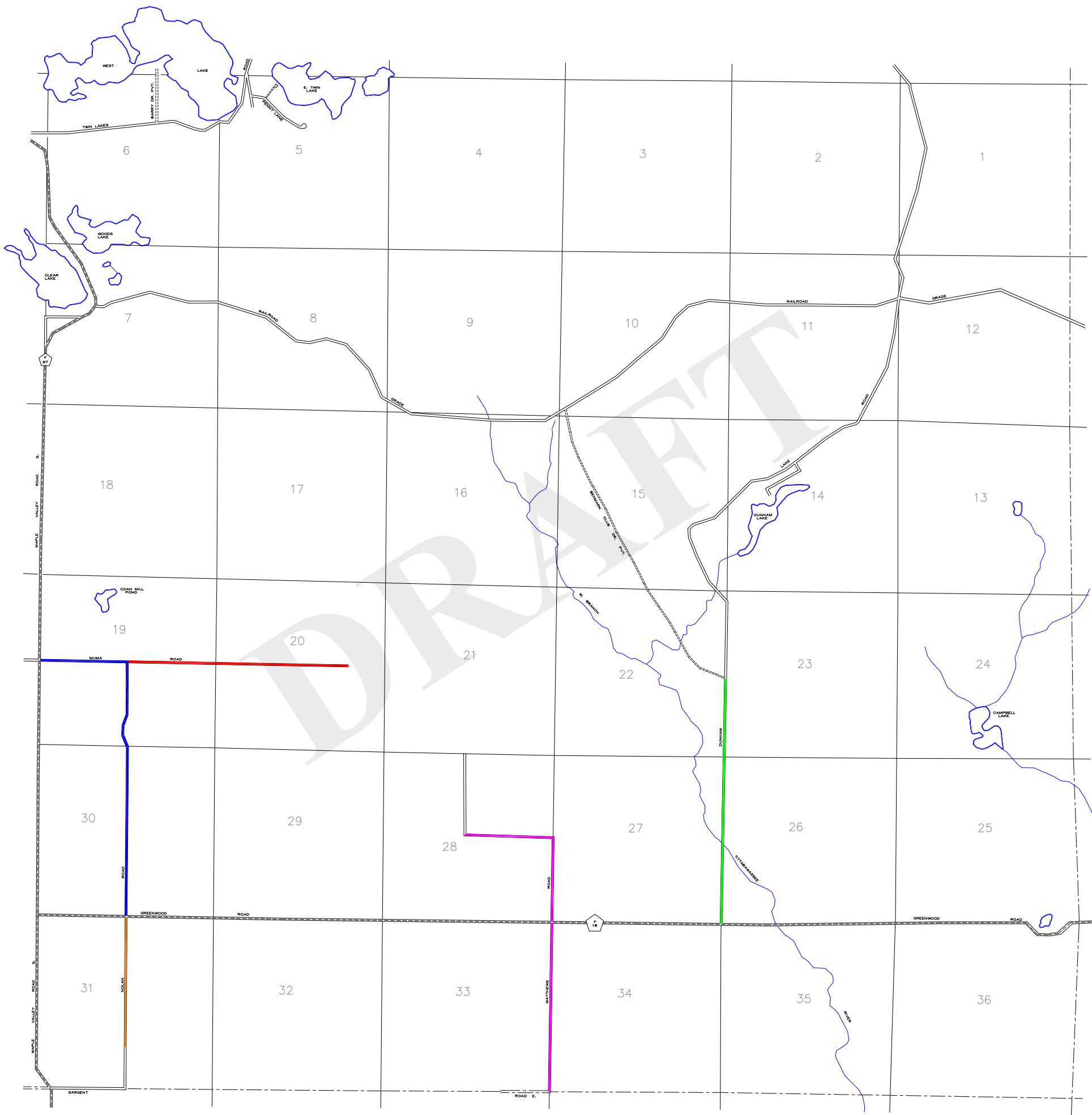

GLADWIN COUNTY

OGE MAW COUNTY

- 2021
- 2022
- 2023
- 2024
- 2025
- 2026