

# ROSCOMMON TWP., PHASE IV B, 2018

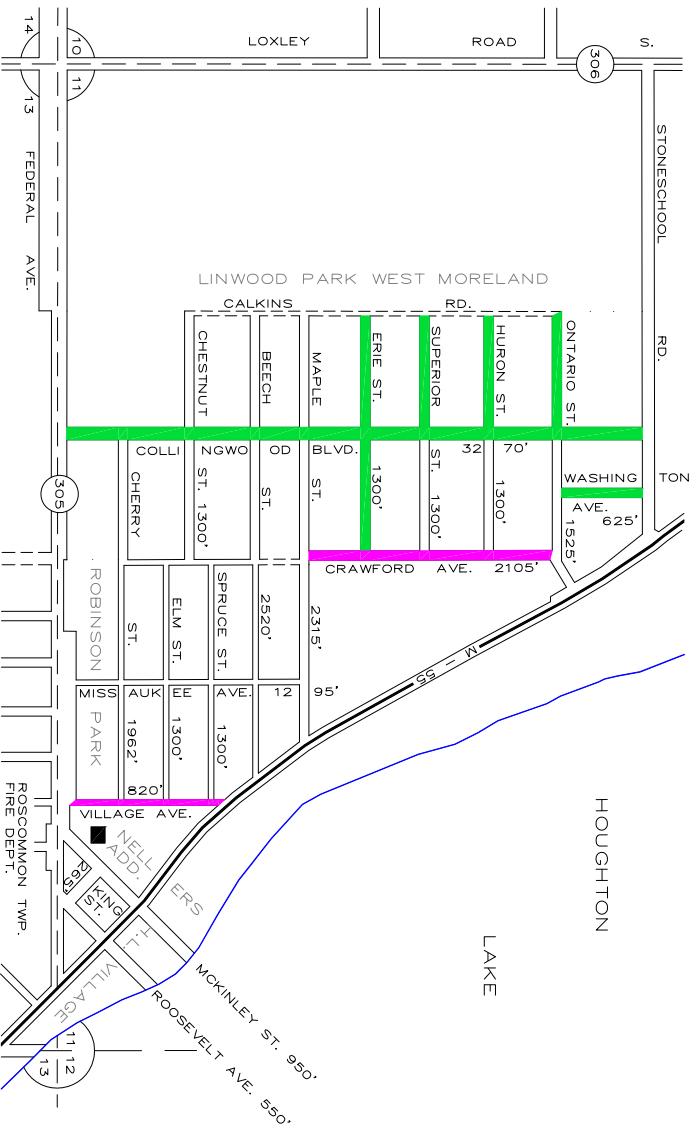

- █ RECON DRAINAGE, CRUSH, SHAPE, AND PAVE
- █ RECON DRAINAGE ONLY



TOWNSHIP ROSCOMMON  
 SECTION 11 T. 22N R. 4W  
 COUNTY ROSCOMMON